

Innocenti Lambretta



Battery, Switches, Rectifiers Parts list

This catalogue was compiled on: 20th Mar 2007, Please check our website for any price changes since that time...

Section

Battery, Switches, Rectifiers

Page No

2

Contact details:

For up to date information and a searchable parts list please visit our web site at:

<http://www.innocentis.co.uk>

You can email us on: info@innocentis.co.uk

You can write to us at:

**Innocenti Ltd
The Lodge, 54 White Street
Martham, Norfolk
United Kingdom
NR29 4PQ**

Telephone: **+44 (0)1493 740658**

Please feel free to contact us if you have any queries, or would like to place an order.

Our hours of business are:

Mon - Fri 0900 - 1700
Sat 0900 - 1300

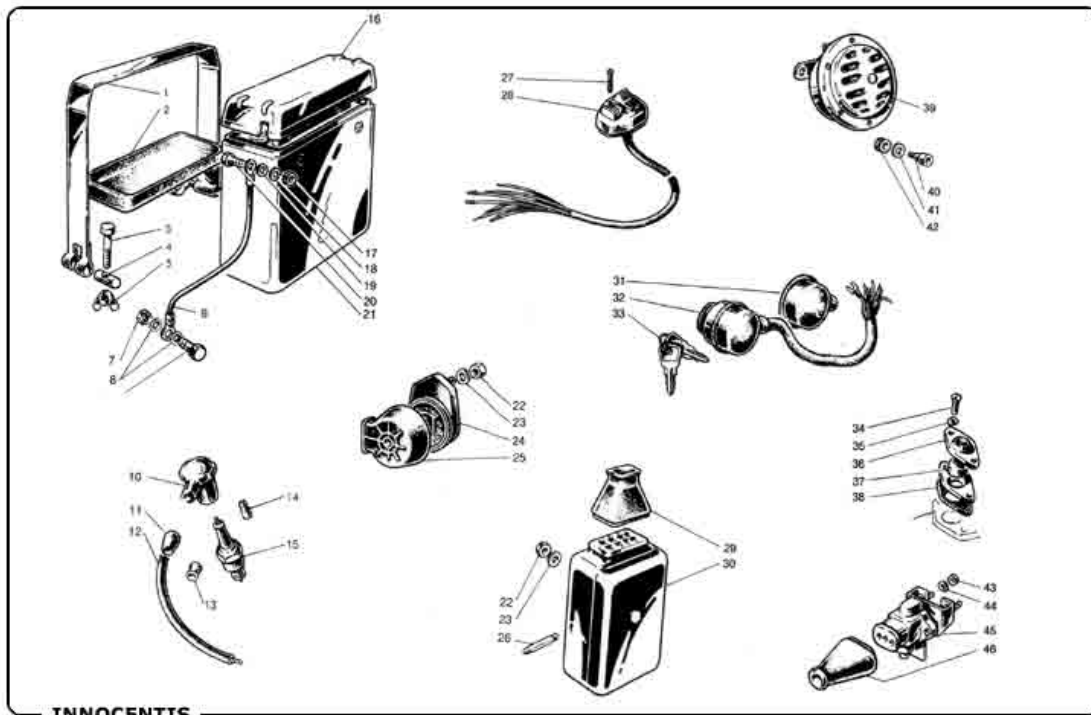

INNOCENTIS

| | | | | | |
|--------|---|--------|--------|--|--------|
| 11-1 | Battery Strap with Rubber & Trunnions Series 3 | £12.50 | 11-32b | LI Series 3 Cut Out Button with Bracket | £10.00 |
| 11-2 | Battery Tray Rubber | £3.00 | 11-32c | LI Series 1 & 2 Cut Out Button with Brackets | £10.00 |
| 11-3 | Battery Strap Rubber | £3.80 | 11-37 | Mag Wiring Grommet | £0.50 |
| 11-6 | Battery Lead 6V DC with Nut & Bolt | £1.50 | 11-38 | Mag. Wiring Plate Gasket | £0.50 |
| 11-6a | Fused Battery Lead 12V DC with Nut & Bolt | £2.50 | 11-39a | Horn 6V DC | £18.50 |
| 11-10 | Spark Plug Cap (NGK) | £2.50 | 11-39b | Horn 12V AC | £18.50 |
| 11-12 | HT Lead (Standard Length for your Scooter) | £2.00 | 11-39c | Horn 12V DC | £12.00 |
| 11-15 | Spark Plug (Champion N2) | £2.50 | 11-39e | Late SX & GP Horn 12V DC with Grommets | £12.00 |
| 11-15a | Spark Plug (Champion N3) | £2.50 | 11-39g | LI Series 3 & Early SX Horn 12V DC | £12.00 |
| 11-15d | Spark Plug (NGK B6ES) | £2.50 | 11-39h | Horn 6v AC Series 1/2 | £12.00 |
| 11-15f | Spark Plug (NGK B8ES) | £2.50 | 11-39i | Horn 12v A/C Series 1/2 | £12.00 |
| 11-15g | Spark Plug (NGK B9ES) | £2.50 | 11-40 | SX/GP Horn Locating Screw | £0.90 |
| 11-15h | Spark Plug (NGK B6HS) | £2.50 | 11-40a | LI Series 3 & Early SX Horn Screw | £0.30 |
| 11-16 | Battery Cover (For Original Type Batteries) | £5.00 | 11-41 | Horn Locating Washer | £0.15 |
| 11-21 | 6 Volt Battery | £12.95 | 11-42 | SX/GP Horn Locating Grommet | £0.90 |
| 11-21a | 12 Volt Battery | £12.95 | 11-45 | Stop Switch (1 Hole) Italian | £7.95 |
| 11-22 | Junction Box (With Resistance) 125cc Series 1 & 2 (Innocenti) | £14.00 | 11-45a | Stop Switch (2 Hole) Italian | £7.50 |
| 11-24a | Junction Box 12V DC Series 3 & GP (Round) | £5.50 | 11-45b | Stop Switch (3 Hole) | £6.00 |
| 11-25 | Junction Box Cover with original Pattern | £3.00 | 11-46 | Stop Switch Protection Cover | £2.60 |
| 11-25a | Junction Box Cover (For Italian Imports) | £4.75 | 11-47a | Horn Bracket Series 3 (Original) | £8.45 |
| 11-26 | Fuse 8 amp | £0.20 | 11-47b | Horn Bracket LI/TV Series 1&2 | £5.50 |
| 11-27 | Light Switch Screw | £0.25 | 11-51 | Male 4mm Bullet Terminal | £0.20 |
| 11-28b | SX/GP Horn/Light Switch (Italian) White | £27.50 | 11-52 | Ring Terminal | £0.20 |
| 11-29 | Rectifier Cap 6V DC | £3.75 | 11-53 | Spade Terminal | £0.20 |
| 11-30 | Ducati Rectifier 6V DC (Innocenti) | £47.00 | | | |